

SWC of SH 225 & Beltway 8 +/- 22 ACRES IN PASADENA TEXAS



PROPERTY OVERVIEW

- ▶ 1290 Ft Frontage on Hwy 225
- ▶ 2 Approved Curb Cuts Hwy 225
- ▶ +/- 22 Acre Land Site
- ▶ City of Pasadena
- ▶ City Utilities Available
- ▶ Key Map 537H
- ▶ Excellent Commercial Site
- ▶ Owner will Divide in Half



GARY A. MABRAY, SIOR
713.830.2104
gmabray@collierstexas.com

MICHAEL J. TAETZ, SIOR
713.830.2107
mtaetz@collierstexas.com

COLLIERS INTERNATIONAL
1300 Post Oak, Suite 200
Houston, Texas 77056
Main: 713.222.2111
Fax: 713.830.2118
www.collierstexas.com

Colliers International is a worldwide affiliation of independently owned and operated companies.

The information contained herein has, we believe, been obtained from reliable sources and we have no reason to doubt the accuracy thereof. All such information is submitted, subject to errors, omissions or changes in condition prior to sale, lease or withdrawal without notice. All information contained herein should be verified by the person relying thereon. We have not made and will not make any warranty or representation as to the condition of the property nor the presence of any hazardous substances or any environmental or other conditions that may affect the value or suitability of the property.

COLLIERS
INTERNATIONAL

FOR SALE

SWC of SH 225 & Beltway 8 +/- 22 ACRES IN PASADENA TEXAS

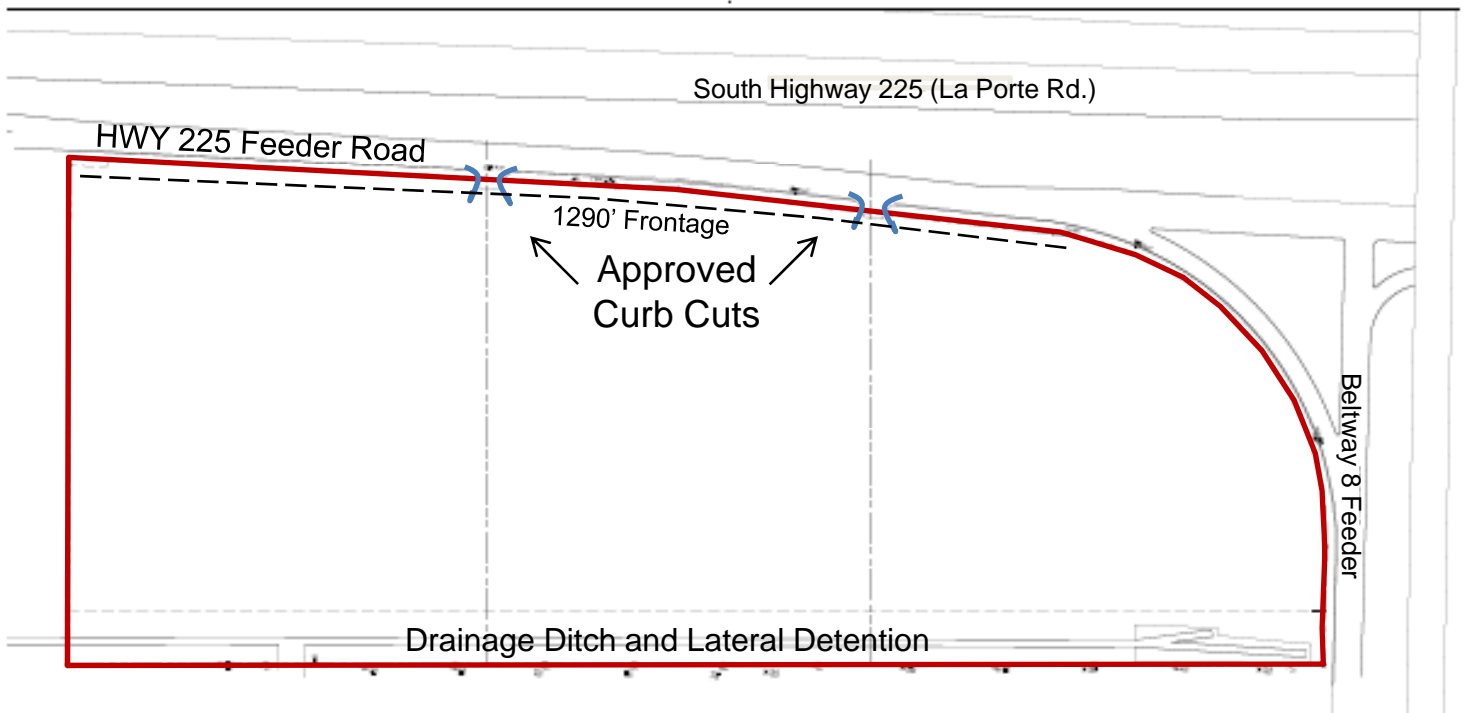

GARY A. MABRAY, SIOR
713.830.2104
gmabray@colliertexas.com

MICHAEL J. TAETZ, SIOR
713.830.2107
mtaetz@colliertexas.com

Colliers International is a worldwide affiliation of independently owned and operated companies. The information contained herein has, we believe, been obtained from reliable sources and we have no reason to doubt the accuracy thereof. All such information is submitted, subject to errors, omissions or changes in condition prior to sale, lease or withdrawal without notice. All information contained herein should be verified by the person relying thereon. We have not made and will not make any warranty or representation as to the condition of the property nor the presence of any hazardous substances or any environmental or other conditions that may affect the value or suitability of the property.



Our Knowledge is your Property