

# Soils Map

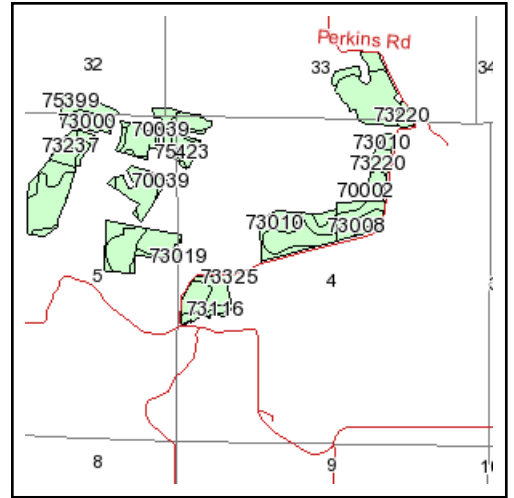

State: **Missouri**  
 County: **Wright**  
 Location: **004-030N-013W**  
 Township: **Montgomery**  
 Acres: **151.8**  
 Date: **6/7/2010**

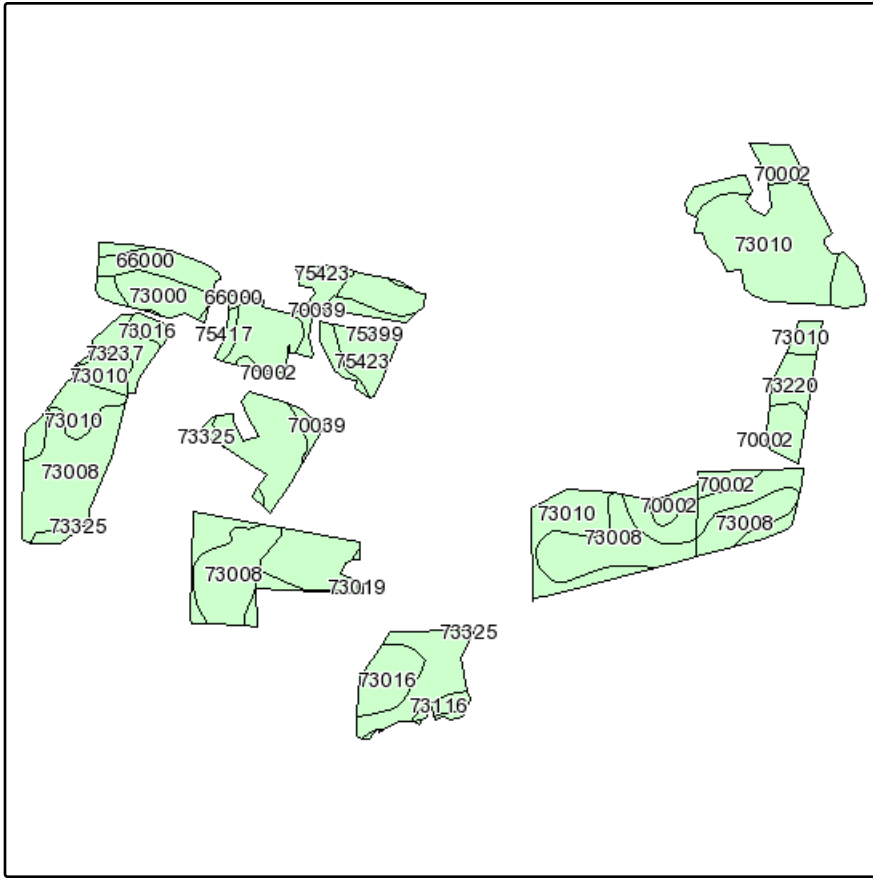
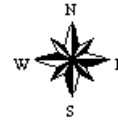

Maps provided by:



©AgriData, Inc 2008  
www.AgriDataInc.com

Fsa borders provided by the Farm Service Agency as of May 23, 2008.  
Soils data provided by USDA and NRCS.

Code	Soil Description	Acres	Percent of field	Non-Irr Class	CSR	Orchardgrass red clover hay	Red clover hay	Tall fescue	Tall fescue red clover hay	
73010	Wilderness gravelly silt loam, 3 to 8 percent slopes	57.8	38.2%	IVs	0					
73008	Viraton silt loam, 2 to 5 percent slopes	32.2	21.2%	IIe	50					
73237	Clarksville very gravelly silt loam, 3 to 15 percent slopes	11.9	7.8%	VIIe	0			3.4	1.7	
70002	Alsop gravelly silt loam, 3 to 8 percent slopes	8.1	5.3%	IIIe	44					
75423	Cedargap very gravelly silt loam, 0 to 3 percent slopes, occasionally flooded	6.2	4.1%	IIIs	0					
73016	Viraton silt loam, 3 to 8 percent slopes	5.9	3.9%	IIIe	0					
74634	Hartville silt loam, 3 to 8 percent slopes	5.2	3.4%	IIIe	0					
73220	Poynor extremely gravelly silt loam, 8 to 15 percent slopes	4.8	3.1%	IVe	0		2	2	4	
66000	Moniteau silt loam, 0 to 2 percent slopes, occasionally flooded	4.3	2.8%	IIIw	0					
73000	Pomme silt loam, 3 to 8 percent slopes	4.3	2.8%	IIIe	0					
75395	Jamesfin silt loam, 0 to 3 percent slopes, occasionally flooded	3.2	2.1%	IIw	0					
75399	Jamesfin silt loam, 0 to 3 percent slopes, frequently flooded	2.2	1.5%	IIIw	0					
70039	Sacville silty clay loam, 1 to 3 percent slopes	2.1	1.4%	IIw	0					
73325	Clarksville extremely gravelly silt loam, 15 to 50 percent slopes	1.3	0.8%	VIIe	0			2.6		
73116	Pomme silt loam, 2 to 5 percent slopes	1.2	0.8%	IIe	0					
75417	Relfe-Sandbur complex, 0 to 3 percent slopes, frequently flooded	0.9	0.6%	IVw	0					
73019	Poynor very gravelly silt loam, 1 to 8 percent slopes	0.2	0.1%	IIIe	0					
<b>Weighted Average</b>						<b>12.9</b>	<b>0.1</b>	<b>0.1</b>	<b>0.4</b>	<b>0.1</b>